

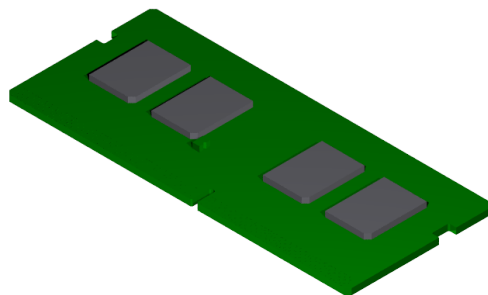

Memory Module

Kit Instructions



7772-K134/K136

Issue D

Copyright

The product described in this document is a licensed product of NCR Voyix Corporation.

NCR CX7 All-in-One POS (7772) is a trademark of NCR Voyix Corporation in the United States and/or other countries. Other product names mentioned in this publication may be trademarks or registered trademarks of their respective companies and are hereby acknowledged.

Where creation of derivative works, modifications or copies of this NCR Voyix copyrighted documentation is permitted under the terms and conditions of an agreement you have with NCR Voyix, NCR Voyix's copyright notice must be included.

It is the policy of NCR Voyix Corporation to improve products as new technology, components, software, and firmware become available. NCR Voyix, therefore, reserves the right to change specifications without prior notice.

All features, functions, and operations described herein may not be marketed by NCR Voyix in all parts of the world. In some instances, photographs are of equipment prototypes. Therefore, before using this document, consult with your NCR Voyix representative or NCR Voyix office for information that is applicable and current.

Copyright © 2019–2024
By NCR Voyix Corporation
Atlanta, Georgia, USA
All Rights Reserved

Table of Contents

Copyright	2
Memory Module	5
Kit Contents	5
Installation Procedure	6
NCR CX7 All-in-One POS (7772)	6
NCR CX8 POS (7736)	10

Revision Record

Issue	Date	Remarks
A	Jul 2019	First Issue
B	Jun 2020	Updated illustrations for steps 4 and 5
C	Aug 2020	Added installation procedure for CX8 (7736)
D	Dec 2021	Added Warning statement

Memory Module

This kit provides a memory module for NCR CX7 All-in-One POS (7772) or NCR CX8 POS (7736).

- **7772-K134** – 8GB Memory Module
- **7772-K136** – 16GB Memory Module

Kit Contents

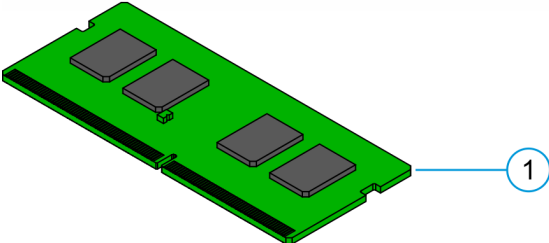

CCP-77008

Item	Part Number	Description
7772-K134 8GB Memory Module		
1	006-8626889	Memory Module – 8GB, DDR4 2400MHz, SO-DIMM, 1.2V
7772-K136 16GB Memory Module		
1	006-8626890	Memory Module – 16GB, DDR4 2400MHz, SO-DIMM, 1.2V

Installation Procedure

Warning

Disconnect the AC power cord from the AC outlet and wait 30 seconds before servicing the terminal.

NCR CX7 All-in-One POS (7772)

1. Lay the Display face down on a flat surface.
Always use a soft material (cloth, foam) to protect the display screen when placing the terminal face down.
2. Remove the Cable Cover.
 - a. Remove the two (2) screws that secure the Cable Cover to the Back Cover.

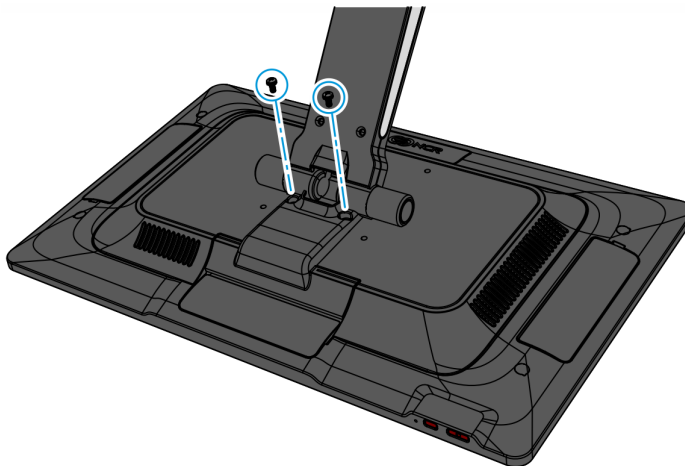

CCP-77013

- b. Rotate and unhook the Cable Cover from the Back Cover.

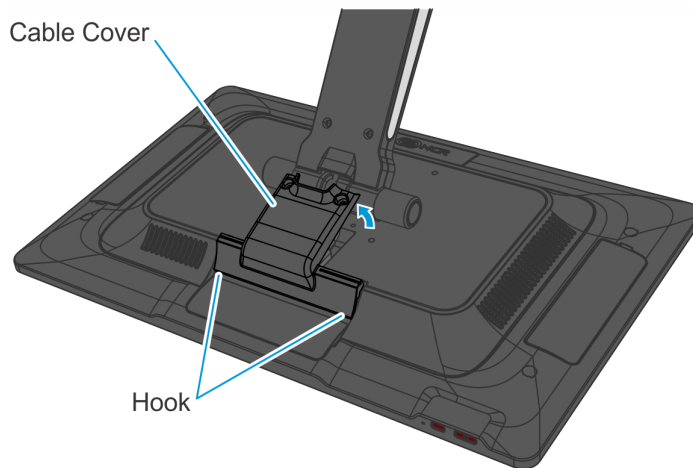

CCP-77014

3. Disconnect the Cables.

- a. Loosen the thumbscrew of the 180-degree USB-C Cable then disconnect the Cable.
- b. Remove the Ethernet Cable from the Cable Management Hook then disconnect the Cable.

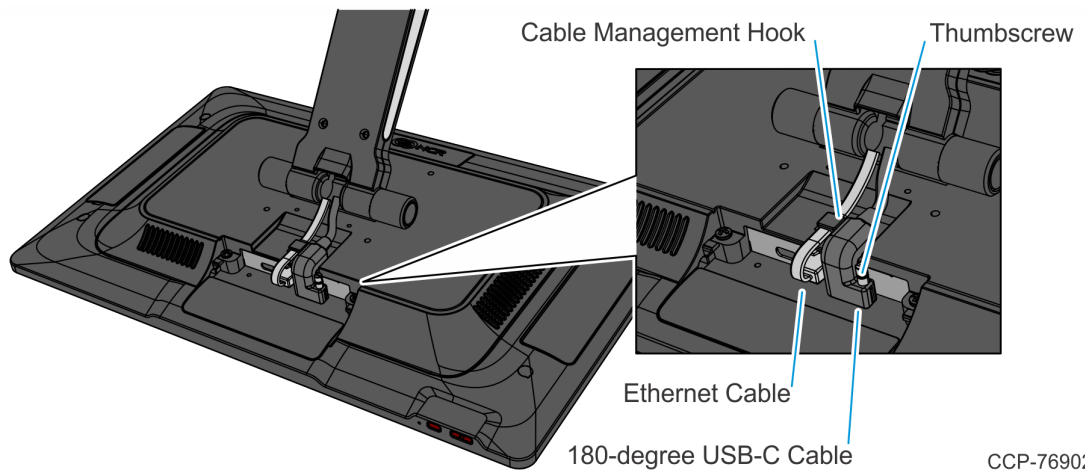

CCP-76902

4. Loosen the two (2) captive screws that secure the Back Cover to the Display.

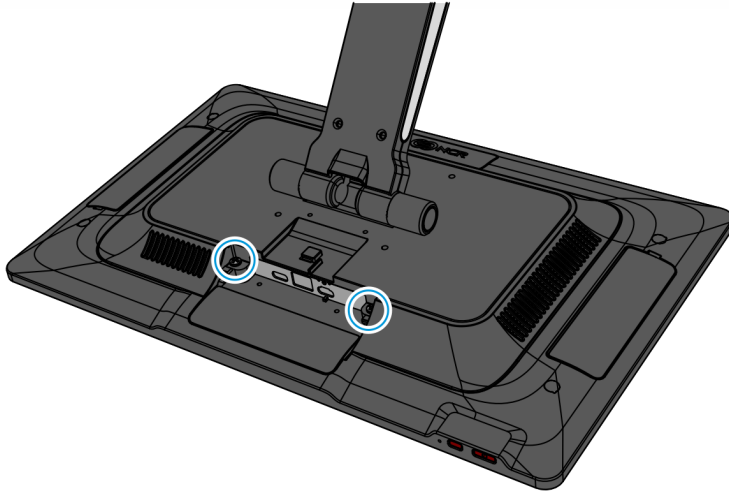

CCP-76903

5. Rotate the Back Cover away from the Display and unhook the Back Cover Tabs.

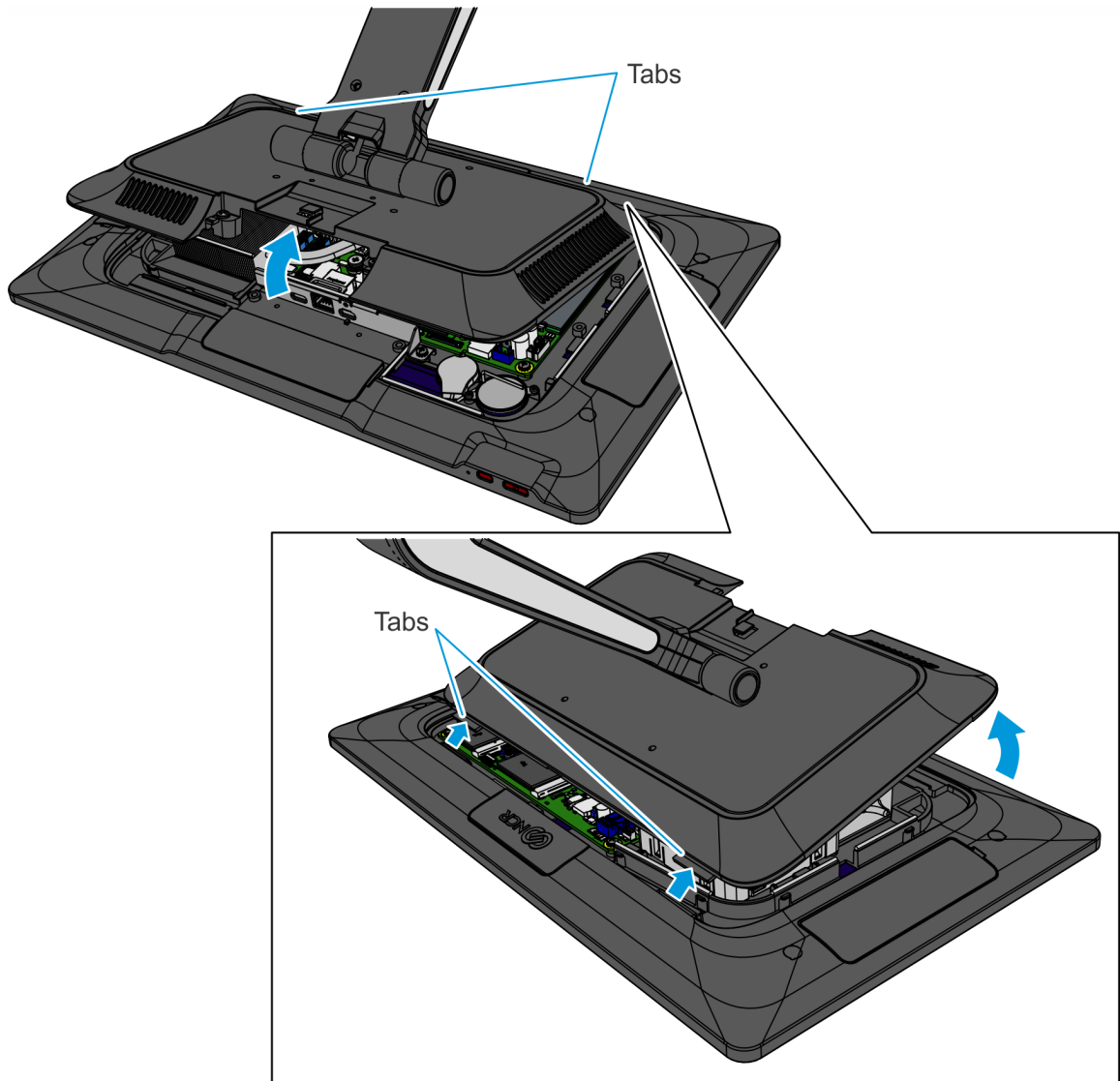

CCP-78836

6. Install the Memory Module in the Socket at an angle as shown.
Memory configurations containing a single memory module should be installed in the lower socket (Socket 1). Memory can be expanded by installing a second module in the upper socket (Socket 2).

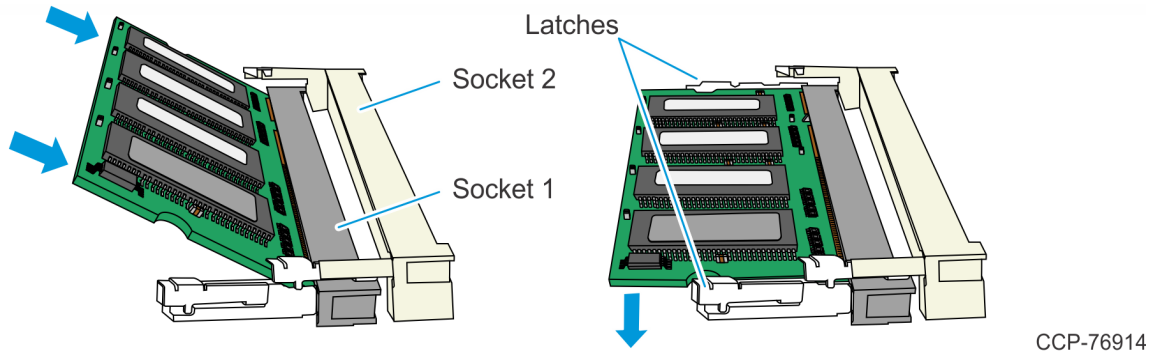

7. Press the Memory Module down until it latches in position. Ensure the latches are completely engaged.
8. Reinstall the Display Back Cover.
9. Reconnect the 180-degree USB-C Cable and Ethernet Cable.
10. Reinstall the Cable Cover.

NCR CX8 POS (7736)

1. Remove the Top Cover. There are two types of Top Covers:
 - **Top Cover without Duct** — Remove the four (4) screws securing the Top Cover to the chassis.

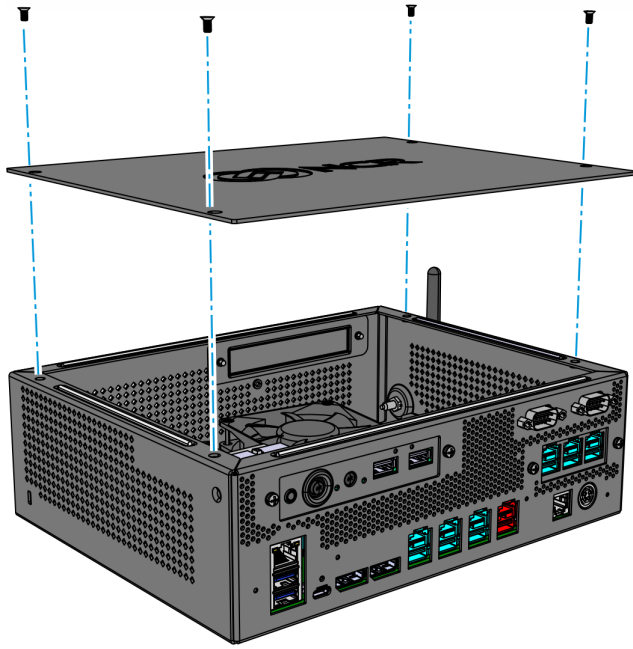

CCP-78820

- **Top Cover with Duct**

- a. Remove the four (4) screws securing the Top Cover to the chassis.

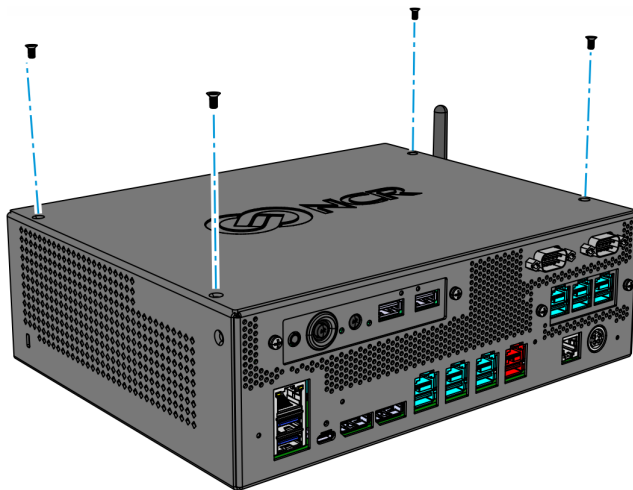

CCP-78856

- b. Slide the Top Cover in the direction shown.

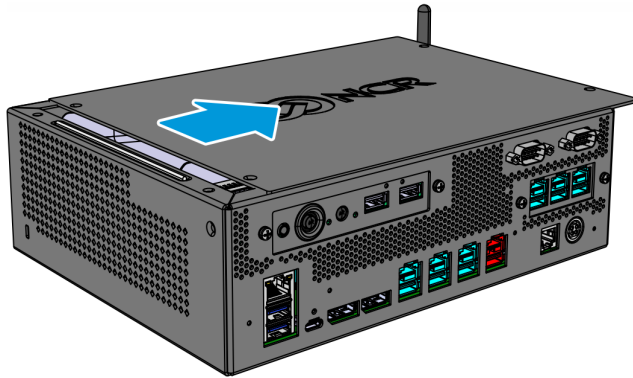

CCP-78857

2. Install the Memory Module in the Socket at an angle as shown. Memory configurations containing a single memory module should be installed in the lower socket (Socket 1). Memory can be expanded by installing a second module in the upper socket (Socket 2).

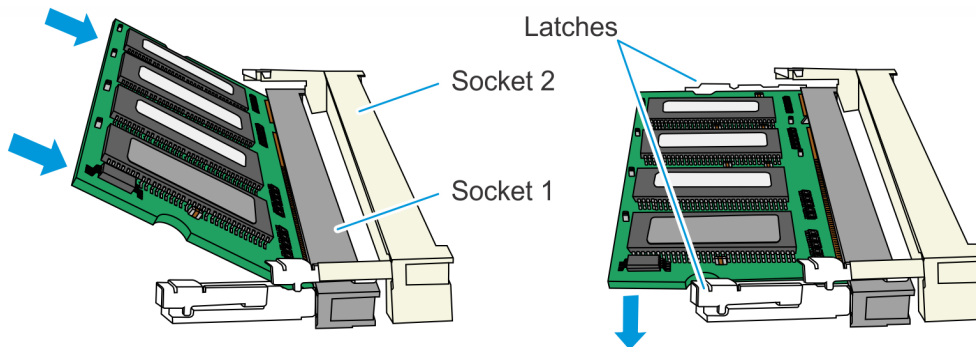

CCP-76914

3. Press the Memory Module down until it latches in position. Ensure the latches are completely engaged.

4. Reinstall the Top Cover.

- **Top Cover without Duct** – Install the Top Cover on the chassis using four (4) screws.

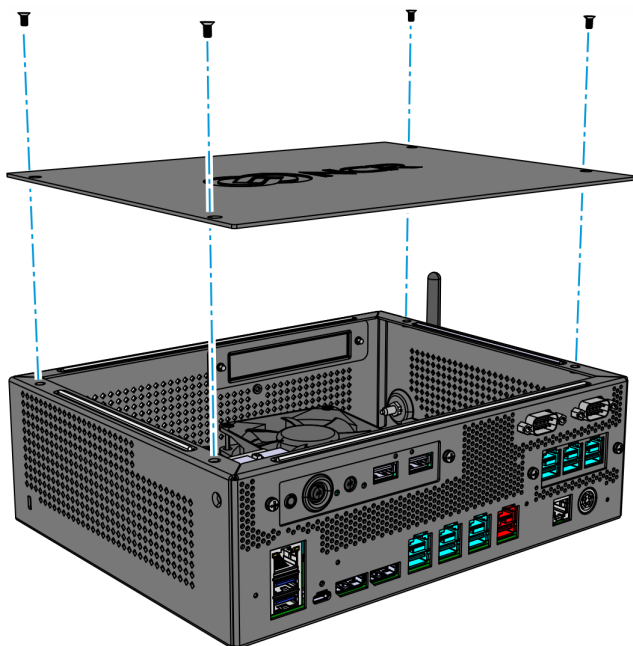

CCP-78820

- **Top Cover with Duct**

- a. Set the Top Cover on the chassis.

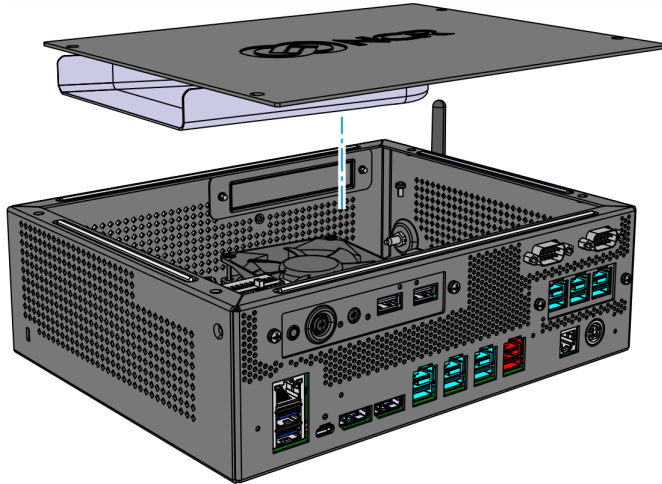

CCP-78858

- b. Slide the Top Cover in the direction shown to align the screw holes of the Cover with the screw holes of the chassis.

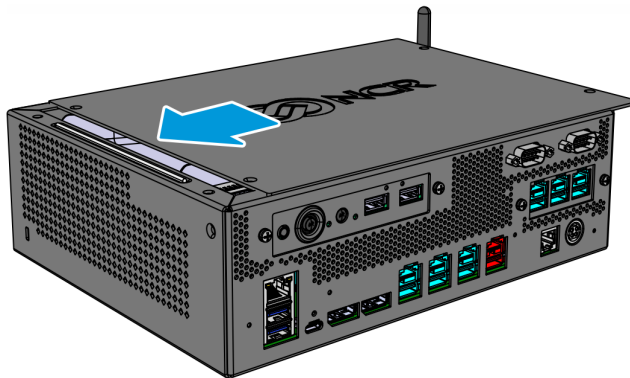

CCP-78859

- c. Secure the Top Cover with four (4) screws.

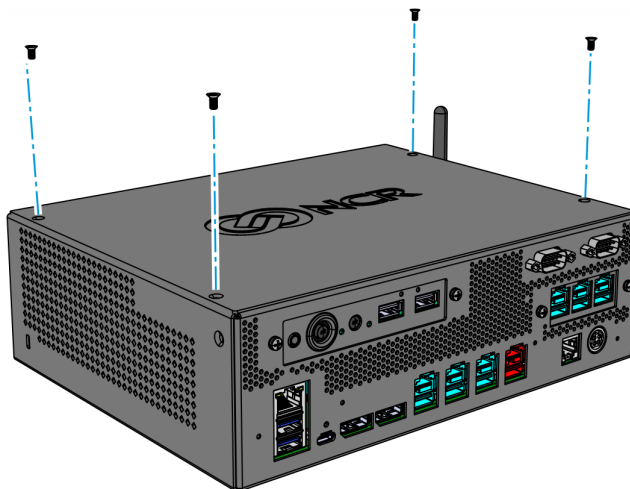

CCP-78856

Confidential and proprietary information of NCR Voyix.
Use and disclose solely pursuant to company instructions.